

47/169

NORTHPOINTE I

A PART OF PIPERS GLEN, A P.U.D.

SITUATE IN SECTION 2, TOWNSHIP 46 SOUTH, RANGE 42 EAST, PALM BEACH COUNTY, FLORIDA, BEING A REPLAT OF TRACT "A1" OF PIPERS GLEN PLAT NO.1(PB.43 P 97-101).

MARCH, 1984 SHEET 2 OF 2

169

STATE OF FLORIDA
COUNTY OF PALM BEACH
THIS PLAT WAS FILED FOR
RECORD AT _____ DAY OF _____
AD, 1984 AND DULY RECORDED
IN PLAT BOOK _____ ON PAGES
AND _____
JOHN B. DUNKLE, CLERK
CIRCUIT COURT
BY: _____, D.C.

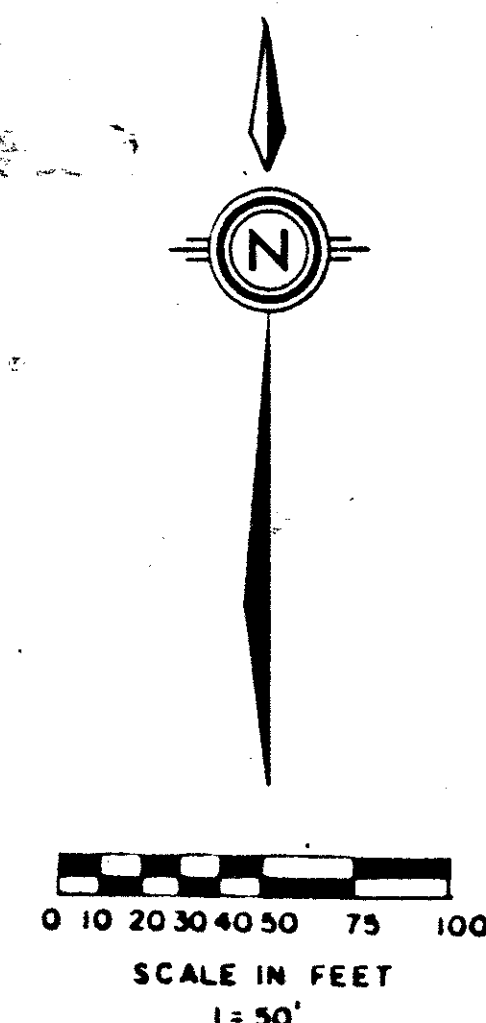

*Site plan Pipers
Glen
A-1*



RECREATION TRACT "F"
(PB.43, PGS.97-101)

RECREATION TRACT "I"
(PB.43, PGS.97-101)

NORTHPOINTE III
(PB. 43, PGS. 97-101)

HOUSING TRACT "A2"
(PB.43, PGS.97-101)

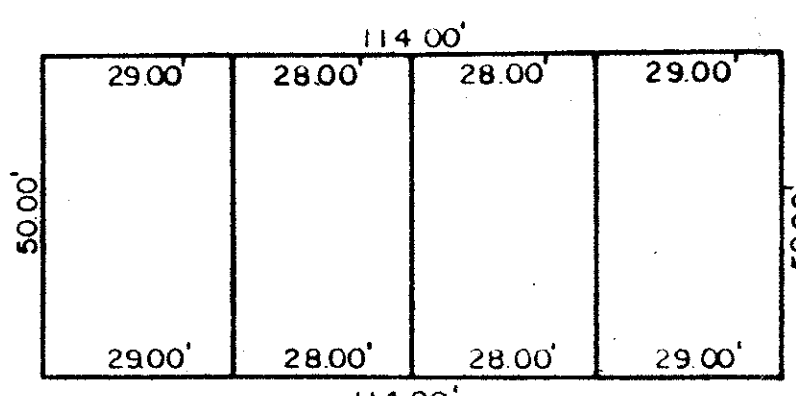

TYPICAL BLOCK
1"=50'

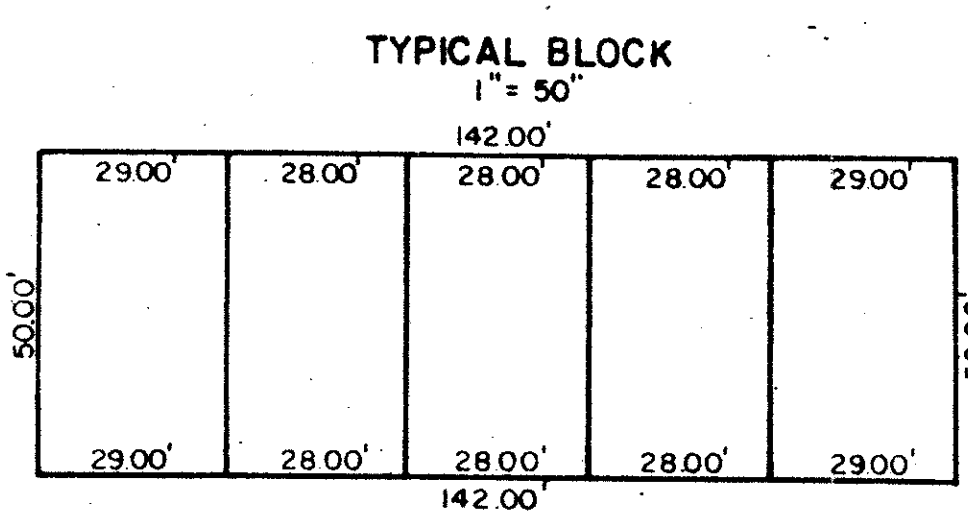

TYPICAL BLOCK
1"=50'

P.U.D. TABULAR DATA

SITE AREA	12.47 AC.
UNITS	57
GROSS DENSITY	5.37 D.U./AC.
% RESIDENTIAL USE	100.00
BUILDING AREA	2.59 AC.
WATER BODIES	1.09 AC.
STREETS & UNCOVERED PARKING	2.02 AC.
RECREATION AREA	0.27 AC.
OPEN SPACE (INCL LAKES)	7.87 AC.
PARKING REQUIRED	83
PARKING PROVIDED	100

0298-300
PUB NAME
PUB NO
PUB DATE
PUB SCALE
PUB MAP

Meridian Surveying and mapping inc. WEST PALM BEACH, FLORIDA

DRAWN BY: H. DATE: DEC. 1983
CHECKED BY: SCALE: 1"=50'
DRAWING NO: 83-P-056

NORTHPOINTE I